

DEAD END

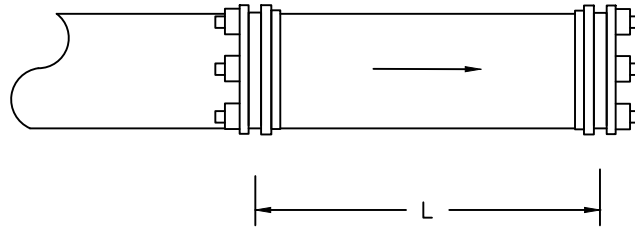

VALVE

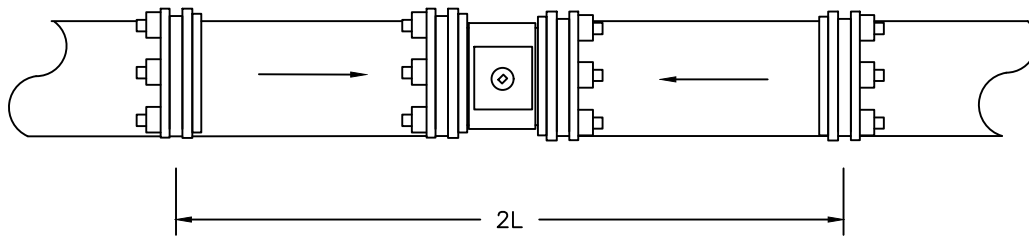

L = LENGTH TO BE RESTRAINED

PIPE SIZE (INCH)	RESTRAINED LENGTH IN FEET, WHEN TEST PRESSURE = 200 PSI
6	59
8	77
10	93
12	109

NOTES:

1. RESTRAINED LENGTH CALCULATIONS ARE FOR PVC PIPE BEDDED IN COMPACTED GRANULAR MATERIAL EXTENDING TO THE TOP OF THE PIPE.
2. THE NATIVE SOIL MATERIAL IS ASSUMED TO BE INORGANIC CLAY OF HIGH PLASTICITY.
3. DEPTH OF BURY IS ASSUMED TO BE 4 FEET
4. THESE CALCULATIONS ARE PROVIDED FOR REFERENCE. THE RESTRAINED LENGTH SHALL BE DESIGNED BASED UPON THE CONDITIONS ENCOUNTERED DURING THE INSTALLATION.

NO REVISION OR MODIFICATION OF THIS DETAIL SHALL BE MADE WITHOUT PRIOR WRITTEN APPROVAL FROM AUGUSTA UTILITIES DEPARTMENT.

REVISED: JANUARY 2018

**RESTRAINED LENGTHS  
FOR DEAD ENDS AND INLINE VALVES**

**AUD DETAIL 3.2.5**

**AUGUSTA UTILITIES DEPARTMENT  
452 WALKER STREET, SUITE 200  
AUGUSTA, GA 30901**

