

TWO PIECE BOX

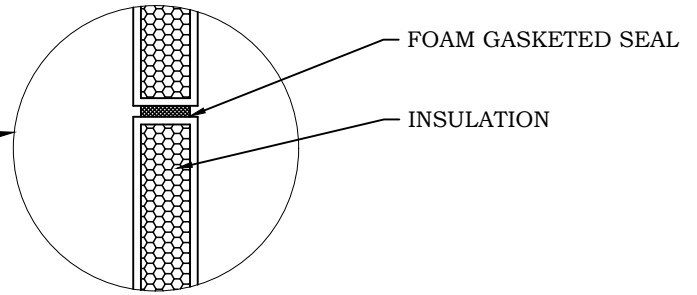

SIDE VIEW OF LIP SEAL

NOTES:

1. BOX SHALL MEET ASSE 1060 STANDARD ENCLOSURE OR EQUAL.
2. BOX SHALL BE SIZED TO RPZ OR DOUBLE CHECK VALVE ASSEMBLIES $\frac{3}{4}$ " TO 12".
3. BOX SHOULD BE INSULATED TO PROTECT FROM FREEZING.
4. ELECTRICAL OUTLET AND HEATER OPTIONAL.

NO REVISION OR MODIFICATION OF THIS DETAIL SHALL BE MADE WITHOUT PRIOR WRITTEN APPROVAL FROM AUGUSTA UTILITIES DEPARTMENT.

APPROVED JAN. 2021

REVISED: JANUARY 2021

RPZ OR DOUBLE CHECK ABOVE GROUND ENCLOSURE ASSEMBLY PROPERTIES

AUD DETAIL 1.22

**AUGUSTA UTILITIES DEPARTMENT
452 WALKER STREET, SUITE 200
AUGUSTA, GA 30901**

